



**CUSTOM
ROOFLIGHTS**



Bi-Fold Doors Installation Guide

**Top Quality Italian Designed
Insulated Aluminium Bi Fold Doors, Including Glass**

YFT70 BIFOLD SYSTEM

Office

01202 802111

Email

info@customrooflights.co.uk

Address

Waterditch Farm, Waterditch Rd,
Christchurch,
Dorset
BH23 7AA

1. Outer Frame

1.1 Temporary installation for balancing

1.1.1 Install top rail profile with 2 (or 3 if needed) screws by balancing and using packers between the profile and wall.

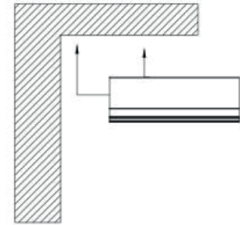

1.1.2 Install side frame profiles by balancing and using packers between profile and wall.

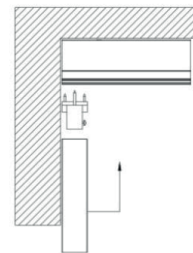

1.1.3 Install bottom rail profile.

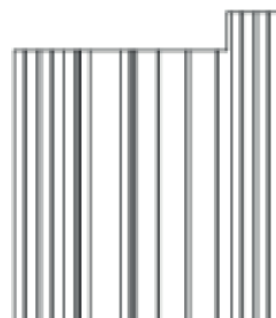
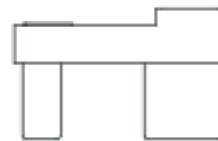
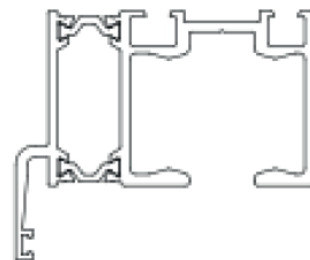
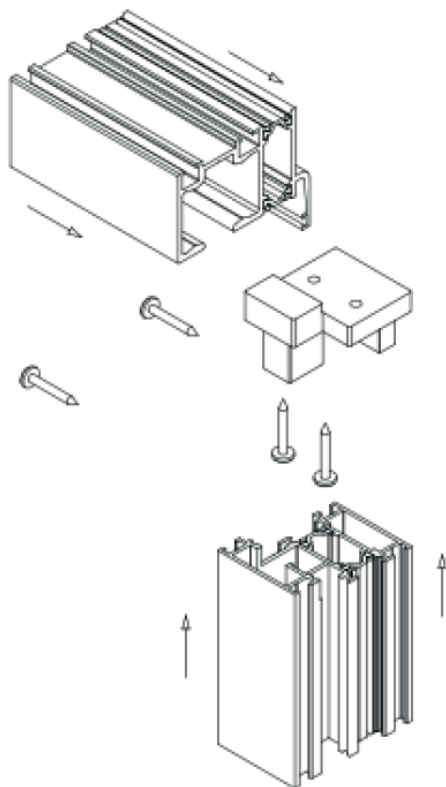
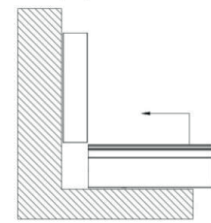

1.2 Fixing The Frame

1.2.1 Screw top rail profile, every 50cm.

Note: Top rail profile is carrier of the system. It should be screwed carefully and sturdily.

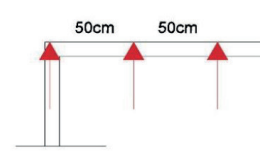

1.2.2 Screw bottom rail profile with 3 screws (or with 4 if the profile is long)

Note: Make the screw head flush with bottom rail channel, using countersink bit to drill a shallow hole. It is recommended to apply silicone to screw heads of bottom rail before screwing, for better insulation.

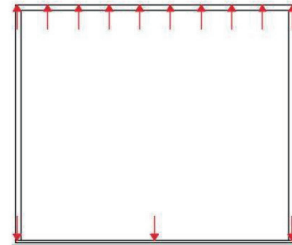

1.2.3 Screw side profiles to the wall with 2 (or more, if needed) screws.

1.2.4 Check the overall balance of the frame and make sure balancing is done accurately.

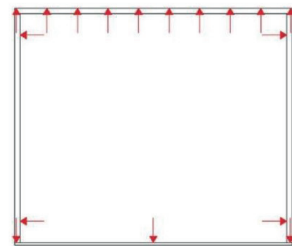

2. Leaves Installation

2.1 Hang the first door leaf by adjusting and screwing hinges to the side profile.

Note: 1 of 4 screws on each side if hinge should be self tapping screw, for leaf not to slide down.

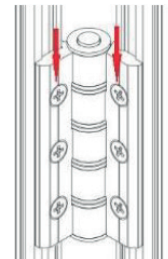

2.2 Before putting second leaf onto the system, screw top roller hinge onto the second door leaf.

2.3 Put the leaf onto frame by fitting top roller through the opening on top rail profile.

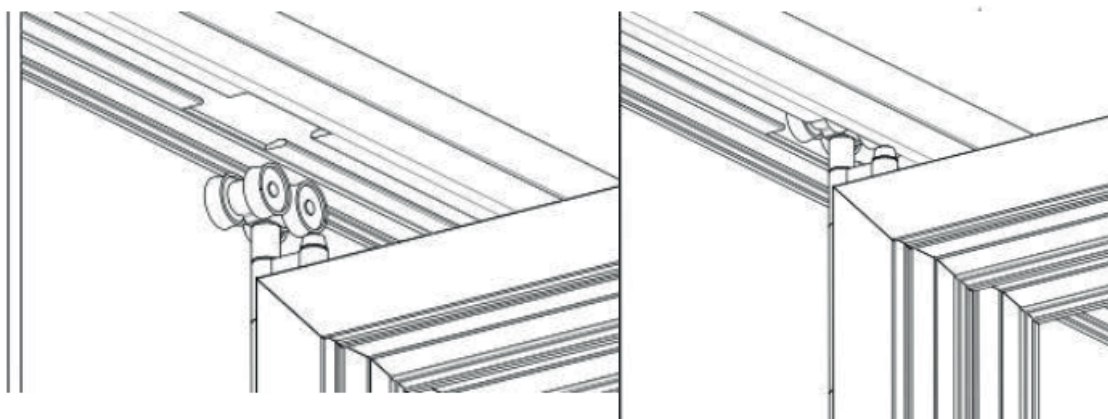
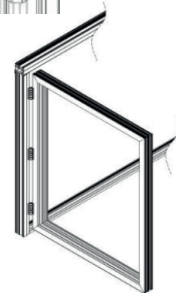

2.4 If the second leaf connects with first leaf, screw the hinges between them.

2.5 Put and adjust bottom guide hinge on the leaves (and in the bottom rail)

2.6 Continue this process according to the number of leaves and system combinations.

2.7 Check if the system is operating properly

Note: Don't forget to check side profile and main door, in particular. Adjust and balance the main door, to operate properly.

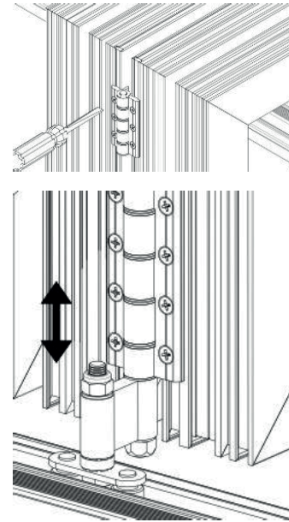

3. Glass Assembly

3.1 Remove the beads from leaves.

3.2 Put packers horizontally and vertically onto the corners, where the normal hinges are located (to the side profile).

3.3 Put glass into the leaf, onto the packers placed.

3.4 While holding glass inside the leaf, lift the leaf from opposite bottom side. While lifting the leaf, place packers to upper diagonal corner of the leaf.

3.5 Release the leaf and put packers to other two corners.

3.6 Repeat the same process for other leaves.

Note: Start putting packers where the leaf is connected to side profile, or where the roller or bottom guide is located.

3.7 Put beads on.

3.8 Put gaskets on.

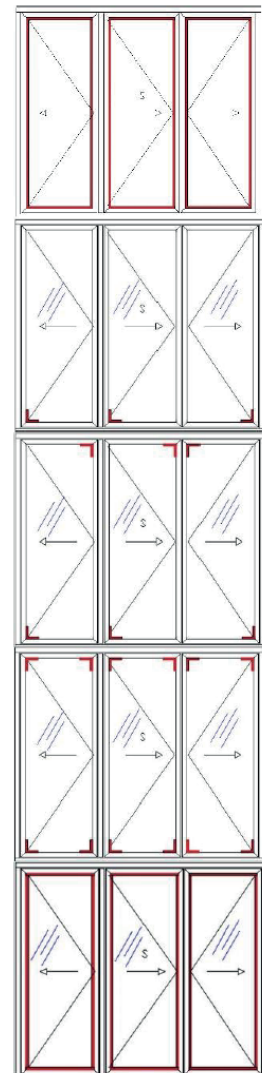

4. Accessories Installation

4.1 Put the handles, cylinder lock, etc.; no certain installation order required.

5. General Control

5.1 Control the system for operation

6. General Notes

6.1 Water drainage: Water drainage inside the channel is already opened. Water should go down into ground, by design. If that is not the case, opening water drainage holes on the bottom rail adapter profile is recommended.



Office

01202 802111

Email

info@customrooflights.co.uk

Website

www.customrooflights.co.uk

Address

Waterditch Farm, Waterditch Rd, Christchurch, Dorset BH23 7AA
